



**CWRU WREB  
Dental Candidate Information Manual**

**Western Regional Examining Board  
March 13– 16, 2020  
(Friday – Monday)**

**CLINICS**



**DMD CLINIC**

**The Samson Pavilion  
Health Education Campus (HEC)**



**SIM LAB**

We at Case Western Reserve University welcome you to our School of Dental Medicine. This manual was developed to help you get acquainted with our facility and its ancillary support systems. We wish you well on this leg of your journey in the profession of Dentistry.

Case Western Reserve University, School of Dental Medicine is making its facilities available to the Western Regional Examining Board (WREB) as a testing site.

This handout is intended to address questions you may have regarding the facility and its role in the examination. If you need any additional information or clarification please contact the Office of the Associate Dean for Administration at 216-368-1900 or [gmi7@case.edu](mailto:gmi7@case.edu). However, please **do not** call the school for any interpretation of material contained in your WREB Candidate Manual.

**Questions regarding the examination itself (content, patient requirements, paperwork/forms, etc.) should be directed to the WREB office: (623-209-5400) [www.wreb.org](http://www.wreb.org)**

## PATIENT PROCUREMENT

*Patient brokering, i.e., the selling of patients, will not be tolerated under any circumstances within the School of Dental Medicine and/or on the premises of the university. Violation of this rule will result in immediate removal from the campus of the university.*

**You must provide your own patients.** The School of Dental Medicine **will not** furnish any patients or make any of its clinic records available for screening or for use during the examination. Further, the School of Dental Medicine has no external sources from which the potential patients can be drawn. You are strongly advised to bring your own patients with you. If you cannot, you will need to explore other alternatives (private practitioners in the area, personal contacts, community shelters, etc.) on your own.

## PATIENT SCREENING

No patient screening will be entertained at CWRU.

## EQUIPMENT AND SUPPLIES

**The following clinic/laboratory supplies will be furnished during the examination:**

Amalgam Alloy (single spill)	Impression materials (see following comments below)
Anesthetic - topical and local	Lab stones
Articulating paper	Lubricant (Vaseline)
Autoclave tape	Masks
Bags, biohazard, sterilization	Matches
Calcium Hydroxide (Dycal)	Mouthwash
Cements (see following comments below)	Needles (27 long) and (30 short)
Cotton rolls and pellets	Paper towels
Cotton-tipped applicators	Patient bibs
Cups (Dixie)	Prisma gloss
Disinfectant Caviwipes and Citrace	Prophy paste
Ethyl alcohol (for torches)	Pumices
Evacuation and saliva ejector tips	Retraction cord
Facial Tissue	Non-Latex Rubber Dam and napkins
Floss, unwaxed	Soap
Gauze sponges (2x2)	Temporary crowns (polycarbonate and ion)
Gloves, examination type (non latex)	Tongue blades
Headrest and chair covers	Tray covers
Hemostatic Agent	Trays for instruments (disposable)
Waxes, various	Exaflex Putty (Regular Set) by GC America

### **Comments:**

The Exaflex material will be available at the Dispensary window and **must** be mixed there.

The putty matrix index must be completed prior to receiving permission to proceed with the Prosthodontic section.

Available impression materials include alginate and vinyl polysiloxane (Aquasil) **only**. You **must** provide any other impression materials you wish to use. Cements on hand include, glass ionomer and hybrid glass ionomer, zinc phosphate, zinc oxide-eugenol, and IRM. **We are a non-latex school.**

We **will be** using shrouds/facemasks in the Endodontic and Prostodontic portion of the exam, the kavo units have shrouds/facemasks already installed so please take note of this prior to choosing a site.

The Prostodontic materials provided in the SIM Clinic will be the following: Exaflex, disposable impression trays, alginate, and stone for impression pour ups. All other equipment and instruments are the Candidate's responsibility.

Supplies furnished for the endodontic portion are listed below. If you use lateral condensation, you **must** supply your own condensers and master/accessory points. **Hand pieces and motors, hand instruments, condensers, spatulas, etc. and burs will not be provided.**

Sodium Hypochlorite  
Files (#10- #80)  
Gauze sponges (2x2)  
Gutta percha

Irrigation syringe  
Paper points (#45 fine, #60 med, #80 coarse)  
Pulp canal sealer (Roth)

For the Endodontic examination in the Den Sim Laboratory, two conventional x-ray units and digital sensors will be provided to acquire radiographs.

You **must** furnish your own equipment (hand pieces and motors, burs, hand instruments, anesthetic syringes, casting rings, investment materials impression trays, casting torch, etc.) Case **will not** provide the cavitron and cavitron tips, you **must** bring your own cavitron + tips to the exam. If an item is not on the foregoing lists, bring it with you. ***The School will assume no responsibility for any omissions in your armamentarium.***

Additionally, for the Endodontic portion of the examination you will need to purchase an Endodontic typodont model # MP\_E 120\_PC. This model is the Magnetic Mount. For the Prosthodontics section, you will be required to purchase the Modu Pro One, MP\_R320. This may be purchased from the following sources:

Acadental (Endo)- **\$214.75** + tax  
Acadental (Prosth)- **\$240.75** + tax  
5830 Woodson, Ste 3  
Mission, KS 66202  
913-384-7390  
[www.acadental.com/wreb](http://www.acadental.com/wreb)

Henry Schein Store (Endo)- **\$194.55** + tax  
Case School of Dental Medicine  
2124 Cornell Road.  
Cleveland, Ohio 44106  
216-368-2771

### **EQUIPMENT RENTAL**

Clinical instruments, hand pieces (high speed and low speed), sonic and ultrasonic scalers **WILL NOT** be available for rental.

All air driven hand pieces are six (6) hole (pictured) in our clinics. If you have a four (4) hole, you will need to provide an adopter to get to six (6) pin. A four (4) hole hand piece **may** leak air therefore, you would need an adapter to convert the hand piece into a six (6) hole.



The School has Bien Air Electric handpiece Control boxes in all operatories in the DMD Clinics and Simulation Clinic. The hand pieces themselves adapt to:

**Bien Air MX2 LED MOTOR # 1600677-001**

**High Speed # CA 1541**

**Slow Speed (Latch) # CA 1142**

**Nose Cone # PM 123**

**All use 6 pin hoses**



**All Electric Hand pieces use Bien Air Hose MX2 400 Grey # 1600700-001**

**[http://www.bienair.com/catalogs/EN/Catalogue\\_Bien-Air\\_Dental\\_EN/catalogue\\_dental\\_en.html#136](http://www.bienair.com/catalogs/EN/Catalogue_Bien-Air_Dental_EN/catalogue_dental_en.html#136)**

**The Air Driven Hand pieces use Bien Air Hose #1600097-001 SN 11D**

**[http://www.bienair.com/catalogs/EN/Catalogue\\_Bien-Air\\_Dental\\_EN/catalogue\\_dental\\_en.html#142](http://www.bienair.com/catalogs/EN/Catalogue_Bien-Air_Dental_EN/catalogue_dental_en.html#142)**

**Extra Information regarding the electric hand pieces CWRU students receive:**

- MX2 electric micro motor
- CA 1:5 Electric High-speed Hand piece
- CA 1:1 Electric Slow speed Hand piece
- PM 1:1 Electric Straight Hand piece
- They also received an Air Driven High-speed which is the Bora L, and it uses the Unifix 4H L coupling

If you have any questions or concerns regarding hand pieces related to the board exam, please e-mail Mr. Adam Majette at [axm696@case.edu](mailto:axm696@case.edu)

The school's in-house student store (Henry Schein) is open Monday-Friday 9:00a.m. to 4:00 p.m. and it will be available thru Saturday during WREB. Inventory is very limited and designed to accommodate our students' needs. Therefore, you are encouraged to contact any of the local dental suppliers listed below if you wish to purchase any instruments or equipment:

Henry Schein	216-368-2771
Patterson Dental	440-891-1050

**CWRU students here use one type of Cavitron and/or Piezo Newtron.**

**Dentsply Cavitron Plus:**



**The Piezo Connection:**



You would have to bring your own cavitron and tips to take the boards at CWRU.

For more information on the Cavitron Plus: <https://www.dentsply.com/en-us/preventive/ultrasonic-scaling/table-top-units.html/Preventive/Ultrasonic-Scaling/Table-Top-Units/Cavitron-Plus-Ultrasonic-Scaler-with-Tap-On-Technology/p/8184001.html#tabs=Features%20and%20Benefits>

If you plan to do any laboratory work in the third floor laboratory, you will also have to utilize equipment that adapts to a four hole system. If you utilize the clinic floor laboratory, you will need a moto tool.

If you have questions in this regard, please contact the Associate Dean for Administration at (216) 368-1900.

**CLINIC OPERATORY EQUIPMENT**

**Each clinic operatory is equipped with Adec units. The operatory unit has:**

1. Bien Air Hose #1600097-001 SN 11D This tubing has coolant water fiber optics and is used with the Air driven high-speed hand piece, Bien Air 6 pin (hole) fiber optics.
2. The control box is available for the Bien Air Electric High Speed, air driven optic high speed with coupling, Bien Air Hose MX2 400, Grey #1600700-001
3. Tri-function air/water syringe
4. A quick-connect water source for ultrasonic scalers.
5. If you prefer to use the electric hand piece, ***you would need to bring:*** latch type electric hand piece, nose cone electric hand piece, MX micro-motor

## LABORATORY EQUIPMENT

**The clinic laboratory** has individual bench spaces with air, electrical and gas outlets only. It also has one model trimmer, two vibrators; one vac-u-spat mixer. You must furnish your own lab burs, alcohol lamps or Bunsen burners and torches.

**The Preclinical** laboratories have individual bench spaces, each equipped with high and slow speed hoses (see page 3 for images). They also have model trimmers, vibrators, and combination vac-u-spat mixers.

**You must furnish your own alcohol lamps or bunsen burners and torches.**

**Please note:**

These rooms will be used for the endodontic and prosthodontic portions of the examination during the day. There are 2 wet labs available for pouring impressions if needed as part of the examination.

## EQUIPMENT MALFUNCTIONS

If you experience any equipment malfunctions report them to the Office of the Associate Dean for Administration at extension (216) 368-1900 or extension (216) 368-6823. An on-site technician will be sent immediately to your area to affect the necessary repairs.

**We encourage the Candidates to visit our school ahead of the scheduled exam to try their instruments and make sure that they are working properly to avoid any accidents during the actual examination.** Please feel free to call Ms. Gladys Ina to schedule a date and time for the visit at 216-368-1900

## INFECTION CONTROL

**Universal Precautions**

The School requires the use of universal barrier protection (gloves, face masks, eyewear, and protective clothing - clinic coats, gowns) during all direct patient contact. Gloves and face masks will be made available, but you will be responsible for providing OSHA-acceptable eyewear for you and your patients.

**Clinic Attire**

You must provide your own clinic attire which must meet the standards imposed by WREB. The school will provide clinic coats and gowns to be worn only in the clinic areas. They may not be worn outside the treatment area.

**Surface Asepsis**

Use of wipe and wire technique for surface disinfectant of the clinic operatory (patient chair, operator and assistant cart/stools, light handles, counter tops, etc.). The following materials and supplies will be available in the clinics for appropriate infection control purposes:

- Caviwipes (at each operatory)
- Citrace spray (at each operatory)
- Plastic chair covers for the dental chair
- Barrier film to cover unit light and handles after disinfection
- Syringe sleeves for air/water syringe handles
- Red biohazard bags for disposal of contaminated items

**Hazardous Waste Disposal**

Place contaminated items (gloves, used gauze, cotton rolls and such disposable as saliva ejectors and evacuation tips) in the plastic red biohazard bag provided. At the end of treatment, deposit these bags in the biohazard-labeled trash-labeled trash receptacles located in each clinic.

**Sharps/Amalgam Disposal**

Place all needles, scalpel blades, and other sharps in the red plastic sharp containers located in every aisle. Place all amalgam scrap in plastic amalgam scrap containers also located in every aisle.

**STERILIZATION**

The main sterilization facility is located on the ground floor of the Dental Clinic. The sterilization schedule will be posted during the examination. Sterilization bags will be available on the Clinic Floor. You must clean/bag your instruments and appropriately identify them to ensure their return to you. Sterilization will not accept any items that have not been appropriately prepared (including candidate identification).

**EMERGENCY PROTOCOL**

For the management of medical emergencies at the School of Dental Medicine, a medical emergency kit is available at the dispensary. Positive pressure oxygen is available in each clinic, and ammonium capsules are available in each operatory. Posted on the wall of each clinic will be the Emergency Protocol of the School. A copy of this protocol is attached (please refer to page 10).

The examiner will have access to the school's automatic external defibrillator (AED) and provide appropriate action according to the American Heart Association (AHA) standards until emergency responders arrive.

**TOUR**

The Candidate tour is held prior to Candidate Orientation. Time TBA

**FOOD/LUNCH FACILITIES**

The Samson Pavilion building has numerous food vending machines on the first floor. There are also numerous restaurants located on Chester Avenue. Information desk staff will be happy to provide you with additional information about local restaurants and other facilities. Candidates should inform their patients to eat before coming to the exam or candidates may choose to bring a small amount of food and beverage for their patients that the on-site. However, food or drink are not allowed in any areas near the candidate clinics or check in desk during the examination.

## DIRECTIONS/PARKING TO THE SCHOOL OF DENTAL MEDICINE

A parking map follows for your convenience.

Please find Parking and Driving Directions on the following link: <https://case.edu/dental/patients-clinics/directions-and-parking-information>

If you need additional assistance in finding the School, please call 216-368-1900.





8  
**HOTELS**

<b>Residence Inn by Marriot</b>	1914 E. 101 <sup>st</sup> Street(walking distance from the school).	216-249-9090
<b>Courtyard Marriott</b>	2021 Cornell Road (down the street)	216-791-5678
<b>Glidden House</b>	1901 Ford Road (located on campus)	216-231-8900
<b>Intercontinental Hotel</b>	8800 Euclid Ave. (corner of Euclid and E. 89 <sup>th</sup> )	216-707-4300
<b>Cleveland Clinic Guest House</b>	9601 Euclid Ave. (corner of Euclid and E. 97 <sup>th</sup> )	216-707-4200 (Call and ask to be directed to the Cleveland Clinic Guest House)
<b>InterContinental Cleveland</b>	9801 Carnegie Avenue Cleveland, Ohio 44106	216.707.4100 855.765.8709 Located less than .3 miles from the HEC campus.
<b>InterContinental Suites Hotel</b>	8800 Euclid Avenue Cleveland, Ohio 44106	216.707.4300 855.268.0352 Located less than .3 miles from the HEC campus.
<b>Holiday Inn Cleveland Clinic</b>	8650 Euclid Avenue Cleveland, Ohio 44016	216.707.4200 844.748.2877 Located less than .3 miles from the HEC campus.

**Downtown/25 minutes - 30 minutes by automobile:**

<b>Crown Plaza Hotel</b>	777 E. St. Clair Avenue	216-771-7600
<b>Embassy Suites</b>	1701 E. 12 <sup>th</sup> Street	216-523-8000
<b>Doubletree Cleveland Downtown</b>	1111 Lakeside Avenue	216-241-5100
<b>Marriott Society Center</b>	127 Public Square	216-696-9200
<b>Renaissance Hotel</b>	24 Public Square	216-696-5600
<b>Ritz-Carlton</b>	1515 W. 3 <sup>rd</sup> Street	216-623-1300
<b>Wyndham Hotel</b>	1260 Euclid Avenue	216-615-7500 Or 877-999-3223

Please contact your hotel choices directly for information about room rates, facilities, proximity to the School of Dental Medicine, transportation, etc.

**Guests of the InterContinental Hotel, InterContinental Suites, and Holiday Inn Cleveland Clinic can board the shuttle just outside the hotels main entrance and request drop off at the HEC.Do not call the School for this information.**

## **MEDICAL EMERGENCY POLICY and PROCEDURES**

### **POLICY:**

- THE SCHOOL OF DENTAL MEDICINE WILL PROVIDE BASIC RESUSCITATION MEASURES WITHIN OUR OWN FACILITY.
- HOSPITAL PHYSICIANS ARE **NOT** AVAILABLE TO COME TO THE CLINIC TO PROVIDE EMERGENCY CARE.
- THE PATIENT IS **NOT** TO BE TRANSPORTED BY SCHOOL OF DENTAL MEDICINE PERSONNEL TO THE EMERGENCY ROOM OF THE HOSPITAL. THIS IS THE RESPONSIBILITY OF THE UNIVERSITY CIRCLE POLICE OR THE EMERGENCY MEDICAL SERVICE.
- NOTIFY CWRU SCHOOL OF DENTAL MEDICINE SAFETY OFFICER AND/OR DISPENSARY MANAGER ANYTIME THERE IS AN EMERGENCY SITUATION.

### **Procedure # 1 - EMERGENCY SITUATIONS IN CLINICAL AREAS DURING NORMAL WORKING HOURS (8:30 am – 5 pm)**

1. Attending student must stay with patient.
2. Attending student summons anyone nearby to call nearest instructor.
3. Attending student and instructor will administer first aid. Basic resuscitative procedures must be initiated as required
  - a. Oxygen is available in each clinic and should be brought immediately to the patient.
  - b. Emergency Kits are located in the DMD Dispensary and Oral Surgery.
  - c. AEDs are located in Oral Surgery and on the wall in the corridor between the A and B clinic.
4. If the instructor requires additional assistance, the **ORAL SURGERY CLINIC** should be called at extension **368-2538 or 368-6749**.
5. If at any time it is deemed that **HOSPITAL EMERGENCY CARE** is indicated, or there is no answer from the Oral surgery clinic, the following steps should be taken:
  - a. Call **UNIVERSITY SECURITY** at extension **368-3333** for transport to University Hospital's emergency room.
  - b. University Security will ask if an ambulance is needed and this should be determined at the advice of the attending Oral Surgery Faculty/Residents or CWRU School of Dental Medicine Safety Officer or by the instructor that takes care of the situation.
6. Do not leave affected person unattended until help arrives.

### **Procedure # 2 - EMERGENCY SITUATIONS IN NON-CLINICAL AREAS DURING NORMAL WORKING HOURS (8:30 am – 5 pm):**

1. Stay with affected person and immediately call for help or summon anyone nearby to call nearest instructor or faculty.
2. Provide basic resuscitation as required.
3. Have the person summoned call the **ORAL SURGERY CLINIC** at extension **368-2538** .If there is no answer from the Oral Surgery Clinic call the **UNIVERSITY SECURITY** at extension **368-3333**.
4. Do not leave affected person unattended until help arrives.

### **Procedure # 3 - EMERGENCY SITUATIONS IN ALL AREAS AFTER HOURS**

1. Call **UNIVERSITY SECURITY** at extension **368-3333**.
2. Provide basic resuscitation as required.
3. Do not leave affected person unattended until help arrives.

### **IMPORTANT NUMBERS TO REMEMBER AND REFER TO:**

<b><u>Department</u></b>	<b><u>Phone number</u></b>	<b><u>Remarks</u></b>
<b>ORAL SURGERY CLINIC</b>	<b>368-2538 368-6749</b>	During normal working hours only (8:30 am to 5 pm)
<b>CWRU SECURITY/POLICE</b>	<b>368-3333</b>	24 hours, 7 days a week
<b>EMERGENCY MEDICAL SERVICE</b>	<b>9-911</b>	First dial 9 for outside line



# DMD CLINIC

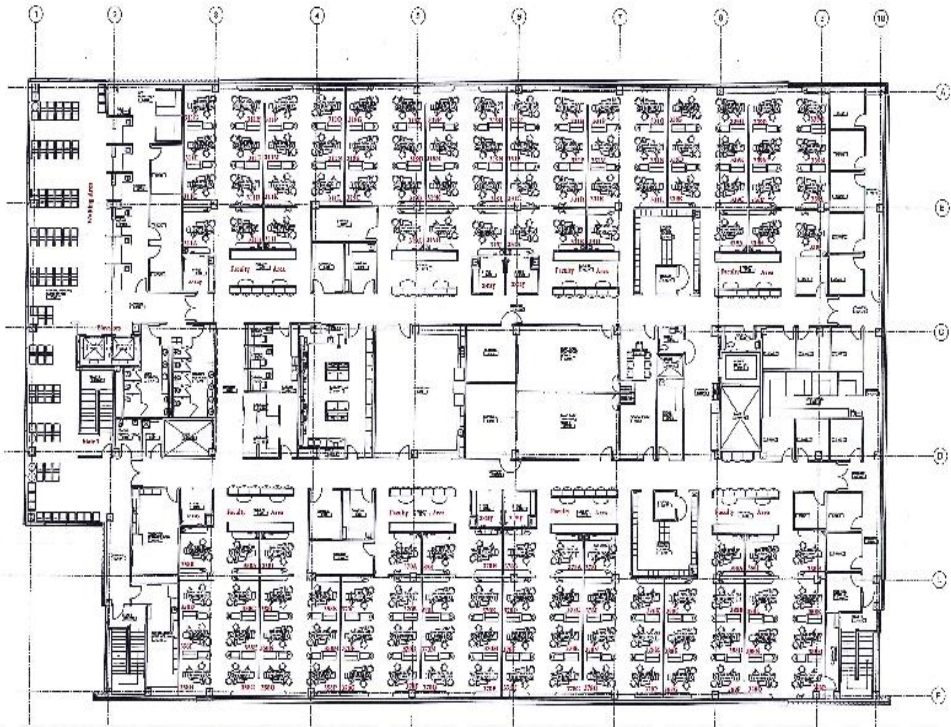

079 00108 B1.1 RE: DMD CLINIC F. A. K. W. L. L. P. C. 07